



VULCAN INDUSTRIES LLC

New Industrial Area, Ajman, UAE, P.O Box 15007

Tel: 06-7436665, 050-6287115, Fax: 06-7437033

Email: info@vulcanuae.com



VULCAN INDUSTRIES LLC

P.O.BOX: 15007, AJMAN, U.A.E.

TEL: +9716-7436665, FAX: +9716-7437033, MOB: +97150-6287115

Email: info@vulcanuae.com, Web: www.vulcanuae.com



ABOUT VULCAN

VULCAN, a pioneer in the design and fabrication of Fire Rated and Non-Fire Rated Steel and Wooden Doors and Frames, with its expansion and diversification have an increased capacity of over 3000 doors and frames in each segment of Steel and Timber per month. The Management's consistent efforts to provide custom made products in line with the hectic schedules, the constant efforts of R&D comprised of well experienced Engineers and the requirements of the clients, have made it possible to achieve a significant role in the domestic and overseas market as a trustworthy supplier. The Company is promoted by highly qualified entrepreneurs and is run by a team of well experienced and qualified personnel.

VULCAN Timber doors are tested as per standards of third party certification from **Warnock Hersey/ITS certification scheme** complying **North American Codes (NFPA 252, ANSI UL 10 (c), UBC 7-2 & CAN4-S104** and **Chiltern International Fire and BM Trada under the scheme of Q Mark Fire Doors complying BS 476 Part 22** for FD30, FD45, FD60, FD90 and FD120 minutes. Vulcan is known for its high performance Sound Proof Doors with **STC up to 42 in Timber and 57 in Steel.**

VULCAN's ability to serve the customers and become a reliable business partner with every supplier and customer are adherent to Entrepreneur principle of "To Serve All Parties with Honesty, Sincerity and Mighty". Vulcan strives for high quality in areas of products and materials and customer services. The raw material purchases are from certified suppliers after strict quality control check to ensure international standards. Vulcan employs high caliber people in every department for efficient, smooth functioning and has well maintained warehouses and transportation systems. Vulcan is committed to provide comprehensive, reliable and efficient pre-sales and after-sales services to its customers. Total customer satisfaction forms the core service goal of the Company.

VULCAN Products are approved by GCC with particular reference to **UAE Civil Defense, Qatar Civil Defense etc.**

VULCAN INDUSTRIES LLC

P.O.BOX: 15007, AJMAN, U.A.E.

TEL: +9716-7436665, FAX: +9716-7437033, MOB: +97150-6287115

Email: info@vulcanuae.com, Web: www.vulcanuae.com



CERTIFICATIONS AND COMPLIANCES

UL 10 B	: Fire Test of Door Assemblies
UL 10 C	: Standard Positive Pressure Fire Test of Door Assemblies
NFPA80	: Fire Doors and Windows
NFPA105	: Installation of Smoke and Draft Control Assemblies
NFPA252	: Fire Test of Door Assemblies
UBC 7-2	: Fire Test of Door Assemblies
Warnock Hersey	: Conformity to ANSI UL 10 C
Local Approval	: UAE Civil Defense Approval
EN 1363-1	: Fire Resistance Tests. General Requirements
EN1363-2	: Fire Resistance Tests. Alternative and Additional Procedure
EN1634-1	: Fire Resistance Tests. Alternative and Additional Procedure

**Conformity Authorities/Certification
Bodies/Standards Authorities/Government
Authorities/Approval Authorities**



VULCAN INDUSTRIES LLC

P.O.BOX: 15007, AJMAN, U.A.E.

TEL: +9716-7436665, FAX: +9716-7437033, MOB: +97150-6287115

Email: info@vulcanuae.com, Web: www.vulcanuae.com

VULCAN

LICENSES/APPROVALS

استمارة رقم (5) ح (سجل)
(ب) تجديد قيد شركة بالسجل

تاريخ تجديد القيد
2012/07/12

نوع الشركة
شركة ذات مسؤولية محدودة

**UNITED ARAB EMIRATES
AJMAN EMIRATE**

دولة الإمارات العربية المتحدة
إمارة عجمان

مديرية البلدية والمخططات - عجمان
Municipality & Planning Dept - Ajman

ECONOMIC LICENSE DEPT

تجديد
رقم 44797
رقم الجواز

رخصة صناعية
أه صناعي رقم (151)

رقم الملف: 53028
أعضاء التصاريح

الانوات

Trade Name: VULCAN INDUSTRIES (L.L.C)

اسم الشركة: فولكان انديستريز (ذات مسؤولية محدودة)
الإسم التجاري: فولكان انديستريز (ذ.م.م)

الشكل القانوني: شركة ذات مسؤولية محدودة
نوع النشاط: صناعة البلاستيك صناعية تكميلية

أسماء المساهمين: إيمان فيا سويت
دانيال سوكو مارل كوناويت

to certify

Industries LLC
P.O.Box 15007
Ajman
Arab Emirates

requirements of
national Scheme for
BS 476 Part 22
index: A Region: 2

Signature
TRADA Certification Ltd
Davies, Group Director

High Wycombe, Buckinghamshire, HP14 4ND
For the scope of this certificate and verification
of this certificate is available through TRADA
at the above address or at www.trada.co.uk
where the property of TRADA Certification Ltd
by whom it must be retained copyright.

ارخصة إنتاج صناعي

الإمارات العربية المتحدة
وزارة الاقتصاد

رقم الملف: 5675
تاريخ المدة: 19/12/2010

الخصم
الإمارات العربية المتحدة

أصحاب التصاريح:
الاسم: علي خليفة بن يوسف
العنوان: رأسخمس سوكو مارل كوناويت
رأسخمس قبا محلة
تاسم يوسف يوسف ستانارا

الإسم التجاري: (فولكان انديستريز) ذ.م.م

المسار: صناعة الأبواب المعدنية ضد الحريق

المنطقة: الصناعة
الاصحاب: صحت
الامارة: عجمان
تاريخ الاصدار: 22/12/2012
تاريخ الانتهاء: 21/12/2013
رقم الاتصال: 000002676712

ادارة التراخيص الصناعية

ارخصة مصنع

دولة الإمارات العربية المتحدة
وزارة الصناعة
الديوانية العامة للصناعة والموتور

تم ترخيص المصنع لصناعة المواد المصنعة استناداً إلى القانون الاتحادي رقم 23 لسنة 2006م في شأن الدفاع المدني والمخارم

الإسم التجاري كمنشأة: فولكان انديستريز ذ.م.م

اسم صاحب الترخيص: علي خليفة بن يوسف التميمي

اسم المصنع: ...

Certificate of Compliance

Report Reference: R28158, 2009 February 05
Issue Date: 2009 April 15

Invested in: ...

Swire Refer A

Have been accordance
UL 108 - UL
Edition, Dated

Additional Information: N/A

Only those products bearing the UL Classification Mark and Follow-Up Service

The UL Classification Mark includes UL in a circle symbol (as shown) and a statement to indicate the category name (product identity) as indicated in the appropriate UL Directory

Look for the UL Classification Mark on the product

International Industrial Certification

Accreditation by the Joint Accreditation System of Australia and New Zealand

VULCAN INDUSTRIES LLC

P.O. BOX NO: 1507, PLOT - 1, NEW INDUSTRIAL AREA,
OPPOSITE AIMS GROUP OFFICE - AJMAN, UAE

This is to certify that the Quality Management System of the above mentioned company meets the requirements of

ISO 9001 : 2008

For the following scope of registration

MANUFACTURING AND DISTRIBUTION OF FIRE RATED STEEL DOORS

Investigated by Underwriters Laboratories Inc.® in accordance with the Standard(s) indicated on this Certificate.

UL Standard for Safety for Fire Tests of Door Assemblies - Tenth Edition April 13, 2009 (NFPA 252).

Classification Mark should be considered as being covered by UL's Classification Mark in a circle symbol (as shown) with the word "CLASSIFIED" (as shown), a control number in a circle symbol to indicate the content of UL's evaluation of the product, and the product name as indicated in the appropriate UL Directory.

Look for the UL Classification Mark on the product

Reviewed by: *Jason Bao*
Senior Professional Engineer
UL, Green Ltd.

Investing UL Mark services are provided on behalf of Underwriters Laboratories Inc. (UL) or any authorized licensee of UL. For more information, visit www.ul.com

VULCAN INDUSTRIES LLC

P.O. BOX: 15007, AJMAN, U.A.E.

TEL: +9716-7436665, FAX: +9716-7437033, MOB: +97150-6287115

Email: info@vulcanuae.com, Web: www.vulcanuae.com



DefenderV

Fire Rated Timber Doors

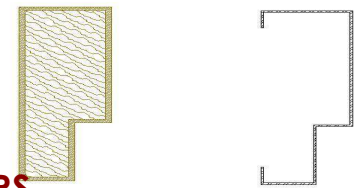
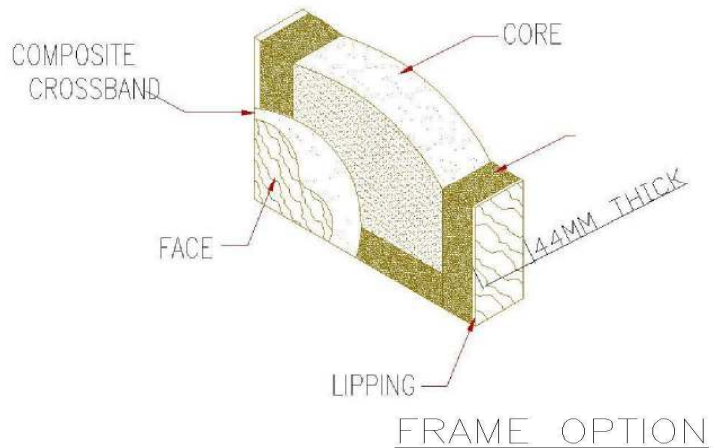
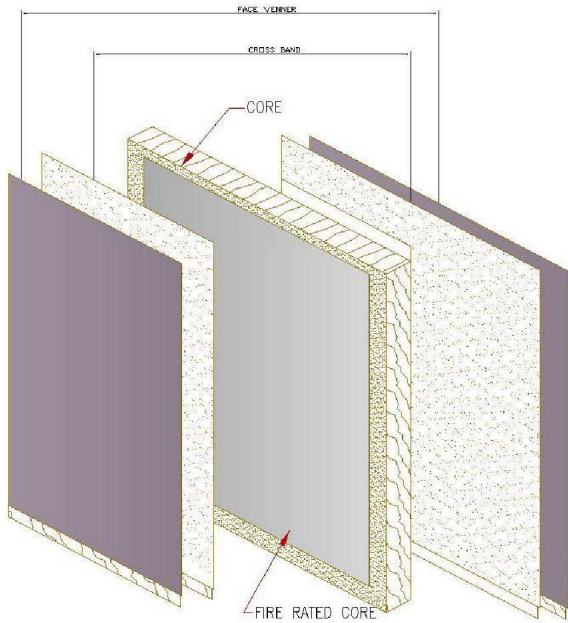

ANSI UL 10 C FIRE RATED DOORS

Door Code	Framing Code	Fire Rating	Maximum Dimension of each Leaf	
			Single (LSASD)	Double (LSADD+DADD)
DefenderVWH30	WDWF/WDMF	30 mts	1219mm Wide x 2743mm high	1219mm Wide x 2743mm high
DefenderVWH45	WDWF/WDMF	45 mts	1219mm Wide x 2743mm high	1219mm Wide x 2743mm high
DefenderVWH60	WDWF/WDMF	60 mts	1219mm Wide x 2743mm high	1219mm Wide x 2743mm high
DefenderVWH90	WDWF/WDMF	90 mts	1219mm Wide x 2743mm high	1219mm Wide x 2743mm high

Core Thickness: 44mm

Door Code	Transom Panel	Side Panel
DefenderVWH30	Door widthx 1016mm high	1219mm wide x 2743mm high
DefenderVWH45	Door widthx 1016mm high	1219mm wide x 2743mm high
DefenderVWH60	Door widthx 1016mm high	1219mm wide x 2743mm high
DefenderVWH90	Door widthx 1016mm high	1219mm wide x 2743mm high

VULCAN INDUSTRIES LLC

P.O.BOX: 15007, AJMAN, U.A.E.

TEL: +9716-7436665, FAX: +9716-7437033, MOB: +97150-6287115

Email: info@vulcanuae.com, Web: www.vulcanuae.com



BS 476 FIRE RATED DOORS

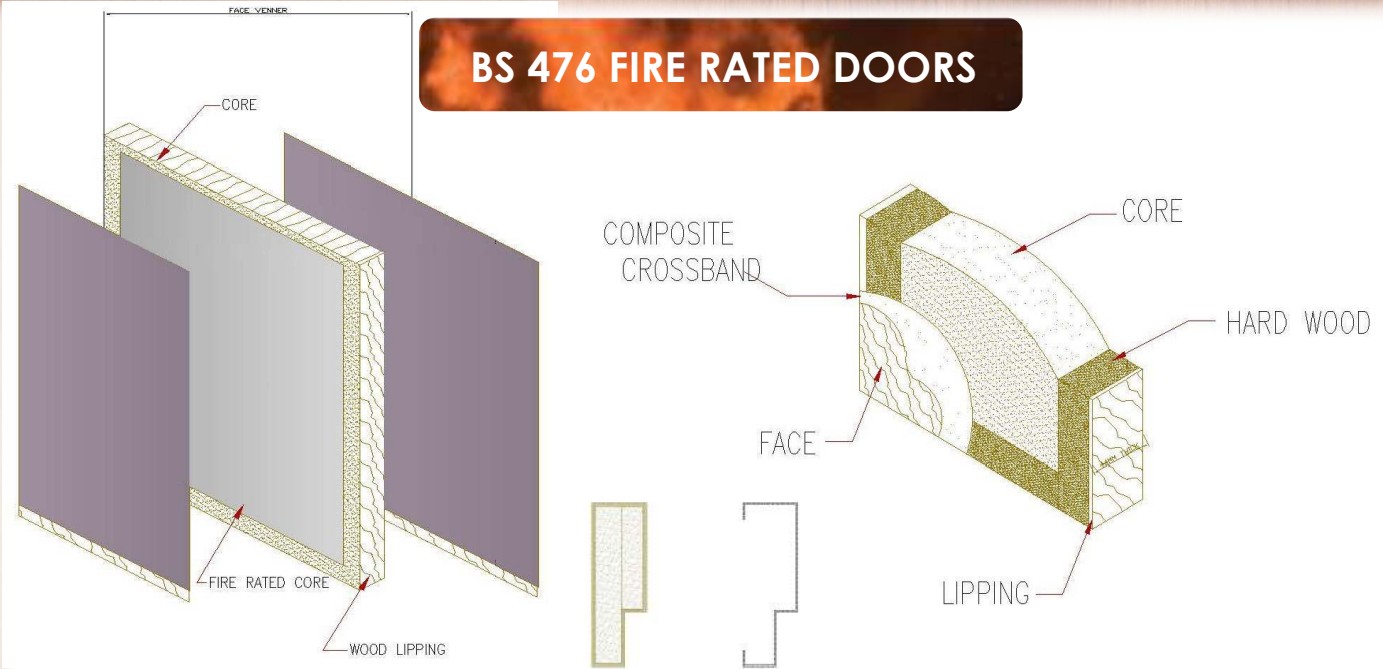

Core Thickness: Varies from 44 mm to 64 mm depending upon Door Model

Door Code	Framing Code	Fire Rating	Maximum Dimension of each Leaf	
			Single (LSASD)	Double (LSADD+DADD)
DefenderVCF30-VHO30	WDMF	30 mts	1638mm wide x 3167mm high	1638mm wide x 3167mm high
DefenderVCF30-VHP30	WDWF	30 mts	1080mm wide x 2428mm high	1080mm wide x 2428mm high
DefenderVCF30-VK30	WDWF	30 mts	1100mm wide x 2585mm high	1100mm wide x 2585mm high
DefenderVCF30-VS44	WDWF	30 mts	1219mm wide x 3223mm high	1219mm wide x 3223mm high
DefenderVCF30-VF44	WDWF	30 mts	1145mm wide x 2632mm high	1145mm wide x 2632mm high
DefenderVCF30-VWS60	WDMF	30 mts	1677mm wide x 3588mm high	1677mm wide x 3588mm high
DefenderVCF60-VHO60	WDWF	60 mts	1227mm wide x 2850mm high	1227mm wide x 2850mm high
DefenderVCF60-VK60	WDWF	60 mts	825mm wide x 2125mm high	825mm wide x 2125mm high
DefenderVCF60-VHP60	WDWF	60 mts	1274mm wide x 3050mm high	1274mm wide x 3050mm high
DefenderVCF60-VS60	WDWF	60 mts	1274mm wide x 2505mm high	1274mm wide x 2505mm high
DefenderVCF60-VF60	WDWF	60 mts	1005mm wide x 2301mm high	1005mm wide x 2301mm high
DefenderVCF90-VK90	WDWF	90 mts	1033mm wide x 2480mm high	1033mm wide x 2480mm high
DefenderVCF90-VWS90	WDWF	90 mts	1463mm wide x 3209mm high	1463mm wide x 3209mm high
DefenderVCF90-VF90	WDWF	90 mts	1011mm wide x 2301 mm high	1011mm wide x 2301 mm high
DefenderVCF120-VH120	WDWF	120 mts	1027mm wide x 2272mm high	1027mm wide x 2272mm high
DefenderVCF120-VWS120	WDWF	120 mts	1234mm wide x 2637mm high	1234mm wide x 2637mm high

VULCAN INDUSTRIES LLC

P.O.BOX: 15007, AJMAN, U.A.E.

TEL: +9716-7436665, FAX: +9716-7437033, MOB: +97150-6287115

Email: info@vulcanuae.com, Web: www.vulcanuae.com



Defender

Fire Rated Timber Doors

FRAME OPTIONS

ANSI/UL

TF-TIMBER FRAME



MF-METAL FRAME

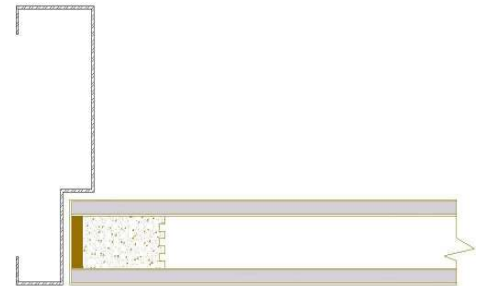

BS

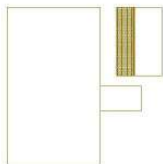

STANDARD

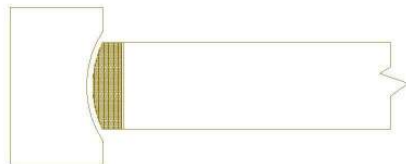

SCALLOPED

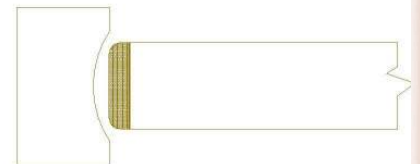

PROFILED EDGES

VULCAN INDUSTRIES LLC

P.O.BOX: 15007, AJMAN, U.A.E.

TEL: +9716-7436665, FAX: +9716-7437033, MOB: +97150-6287115

Email: info@vulcanuae.com, Web: www.vulcanuae.com



NON FIRE RATED TIMBER DOOR

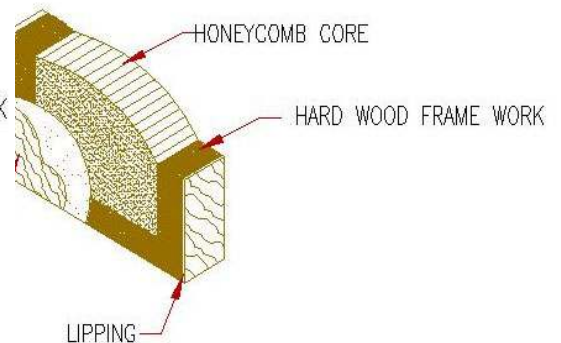
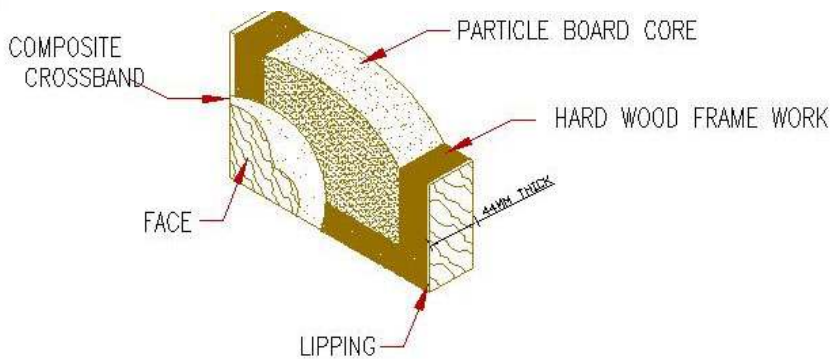
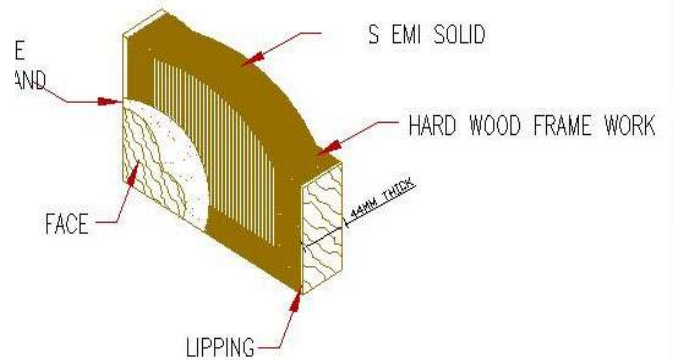
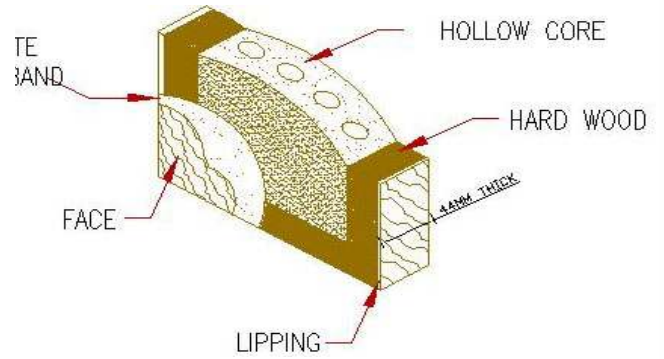
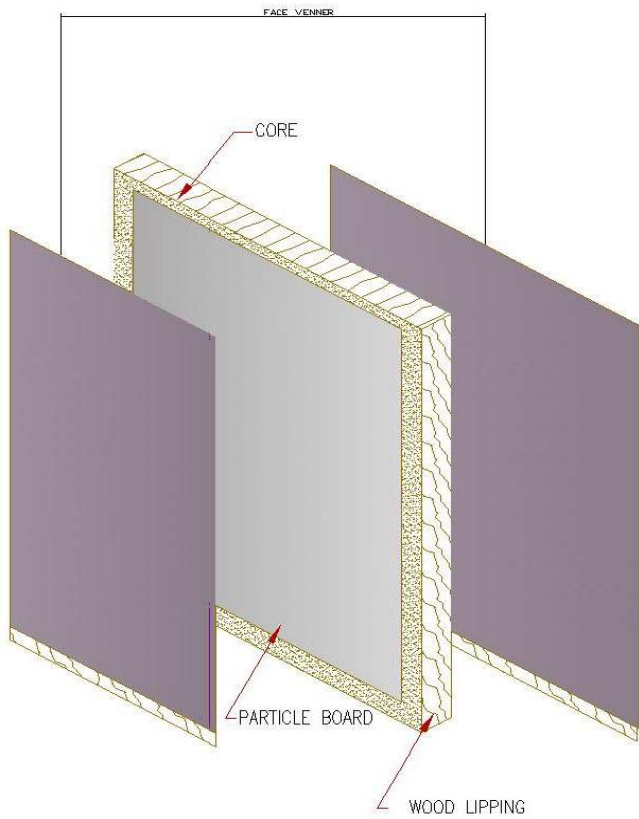

VULCAN INDUSTRIES LLC

P.O.BOX: 15007, AJMAN, U.A.E.

TEL: +9716-7436665, FAX: +9716-7437033, MOB: +97150-6287115

Email: info@vulcanuae.com, Web: www.vulcanuae.com



HARDWARES



HINGES

Butt Ball Bearing Hinges with 3 and 5 Knuckles to Euro and US Templates sizes and standards. Options available are NRP, Hospital Tip, Concealed edge, Single and Double Spring and rising Hinges.



LOCK MORTISE

Available as per ANSI 1000Series, with functions F01, F02, F14, F16, F17, F18, F21 & F22. The premium features of this model is its Fire rating as per EN 1634-1 & UL 10C with above features the lock is the most competitively priced in its range of products.



CLOSERS

Power Ranging from 2 to 6 with covers available in 18 and more finishes. The base material of cover has options for PVC and Steel. Dual valve construction controls speed of closing and latching of the door. Other options features available are back Check, hold Open, Handing, Mounting (Surface, Concealed & Floor).



EXIT DEVICES

Horizontal and Vertical Exit devices made with Non Ferrous alloys and Steel available with options for handing, color outside trim and dogging, Extra rod is available for oversize doors to meet the requirements of the door height.



LOCK CYLINDRICAL

Horizontal and Vertical Exit devices made with Non Ferrous alloys and Steel available with options for handing, color outside trim and dogging, Extra rod is available for oversize doors to meet the requirements of the door height.

VULCAN INDUSTRIES LLC

P.O.BOX: 15007, AJMAN, U.A.E.

TEL: +9716-7436665, FAX: +9716-7437033, MOB: +97150-6287115

Email: info@vulcanuae.com, Web: www.vulcanuae.com

VULCAN

veneers

Defender
Fire Rated Timber Doors



VULCAN INDUSTRIES LLC

P.O.BOX: 15007, AJMAN, U.A.E.

TEL: +9716-7436665, FAX: +9716-7437033, MOB: +97150-6287115

Email: info@vulcanuae.com, Web: www.vulcanuae.com



120 MINUTES FIRE RATED EN

Mineral Core manufactured in accordance with US patterns and has ITS/WH certification Labour.Cores are reinforced with blocking the hardware Installation & Screws (Fire Rated Door Sets are to be complimented by Ironmongery having Test Evidence for Fire Rating and additional Intumescent for them. Fire Rated doors are IT'S/WH approved.

Core	Mineral Core of 481 kg/m3 density
Cross bands	3.0 mm MDF
Faces	0.6 mm veneer
Joining Method	Bonded Finger Joint
Lipping 4 side	43x10, Density 650 kg/m3
Intumescent	As per tested code category A to E on shutter and 36 x 6 mm on frame
Finishing	Sanding, Sealer and Glazed
Adhesive	PVA adhesive
Frame	Mineral core frame & Metal Frame
Hinges	Height of 101.6 mm to 114.3 mm and Thickness of 2.67 mm to 5.72 depending on door width and height
Closers	Listed and Labelled, Surface mounted and concealed
Latch/Locks	Listed and Labelled. Minimum Latch throw of 12.7 mm for single and 16 mm for double
Mortise	Mortise latchset of 27mm x 114mm x 165 mm
Fire Exit Hardware	Listed and Labelled Fire exit device
Bolts	Listed and Labelled
Lite Kits	Positive Pressure as per UBC standard 7-2-1997, UL 10C
Positive Pressure	Frame smoke seal
Testing Standards	EN 1634-1:2000
Stiles	High Density Mineral core-Minimum thickness of 25.4 mm with or without 6.4 mm wood edge
Rails	Mineral Core-Top and Bottom Minimum of 25.4 mm width
Thickness	43 mm
Veneer	As per requirement
Glazing	N/A

VULCAN INDUSTRIES LLC

P.O.BOX: 15007, AJMAN, U.A.E.

TEL: +9716-7436665, FAX: +9716-7437033, MOB: +97150-6287115

Email: info@vulcanuae.com, Web: www.vulcanuae.com



90 MINUTES FIRE RATED UL

Mineral Core manufactured in accordance with US patterns and has ITS/WH certification Labour.Cores are reinforced with blocking the hardware Installation & Screws (Fire Rated Door Sets are to be complimented by Ironmongery having Test Evidence for Fire Rating and additional Intumescent for them. Fire Rated doors are IT'S/WH approved.

Core	Mineral Core of 481 kg/m ³ density
Cross bands	3.0 mm MDF
Faces	0.6 mm veneer
Joining Method	Bonded Finger Joint
Lipping 4 side	43x10, Density 650 kg/m ³
Intumescent	As per tested code category A to E on shutter and 36 x 6 mm on frame
Finishing	Sanding, Sealer and Glazed
Adhesive	PVA adhesive
Frame	Mineral core frame & Metal Frame
Hinges	Height of 101.6 mm to 114.3 mm and Thickness of 2.67 mm to 5.72 depending on door width and height
Closers	Listed and Labelled, Surface mounted and concealed
Latch/Locks	Listed and Labelled. Minimum Latch throw of 12.7 mm for single and 16 mm for double
Mortise	Mortise latch set of 27mm x 114mm x 165 mm
Fire Exit Hardware	Listed and Labelled Fire exit device
Bolts	Listed and Labelled
Lite Kits	Positive Pressure as per UBC standard 7-2-1997, UL 10C
Positive Pressure	Category A, B- Mineral Core, C-standard frame edge sealing, G-edge sealaly system, H-smoke & draft control gasketing
Testing Standards	UBC-7-2-97/UL 10 C Positive Pressure
Stiles	High Density Mineral Core 40mm x 30 mm of 1263-1378 kg/m ³ density
Rails	High Density Mineral Core 40mm x 30 mm of 1263-1378 kg/m ³ density
Thickness	43 mm
Veneer	As per requirement
Glazing	Maximum Area of 100 sq.in

VULCAN INDUSTRIES LLC

P.O.BOX: 15007, AJMAN, U.A.E.

TEL: +9716-7436665, FAX: +9716-7437033, MOB: +97150-6287115

Email: info@vulcanuae.com, Web: www.vulcanuae.com



60 Minutes Fire rated UL

Mineral Core manufactured in accordance with US patterns and has ITS/WH certification Labour. Cores are reinforced with blocking the hardware Installation & Screws (Fire Rated Door Sets are to be complimented by Ironmongery having Test Evidence for Fire Rating and additional Intumescent for them. Fire Rated doors are IT'S/WH approved.

Core	Mineral Core of 481 kg/m3 density
Cross bands	3.0 mm MDF
Faces	0.6 mm veneer
Joining Method	Bonded Finger Joint
Lipping 4 side	43x10, Density 650 kg/m3
Intumescent	As per tested code category A to E, 36 x 6 mm on frame
Finishing	Sanding, Sealer and Glazed
Adhesive	PVA adhesive
Frame	Mineral core frame & Metal Frame
Hinges	Height of 101.6 mm to 114.3 mm and Thickness of 2.67 mm to 5.72 depending on door width and height
Closers	Listed and Labelled, Surface mounted and concealed
Latch/Locks	Listed and Labelled. Minimum Latch throw of 12.7 mm for single and 16 mm for double
Mortise	Mortise latch set of 27mm x 114mm x 165 mm
Fire Exit Hardware	Listed and Labelled Fire exit device
Bolts	Listed and Labelled
Lite Kits	Positive Pressure as per UBC standard 7-2-1997, UL 10C
Positive Pressure	Category A, B- Mineral Core, C-standard frame edge sealing, G-edge seal system, H-smoke & draft control gasketing
Testing Standards	UBC-7-2-97/UL 10 C Positive Pressure
Stiles	High Density Mineral Core 40mm x 30 mm of 1263-1378 kg/m3 density
Rails	High Density Mineral Core 40mm x 30 mm of 1263-1378 kg/m3 density
Thickness	43 mm
Veneer	As per requirement
Glazing	Maximum Area of 100 sq.in

VULCAN INDUSTRIES LLC

P.O.BOX: 15007, AJMAN, U.A.E.

TEL: +9716-7436665, FAX: +9716-7437033, MOB: +97150-6287115

Email: info@vulcanuae.com, Web: www.vulcanuae.com



45 MINUTES FIRE RATED UL

Fire rated doorsets are to be complemented by Ironmongeries having test evidence of Fire Rating.

Core	Mineral Core of 481 kg/m ³ density
Cross bands	3.0 mm MDF
Faces	0.6 mm veneer
Joining Method	Bonded Finger Joint
Lipping 4 side	43x10, Density 650 kg/m ³
Intumescent	As per tested code category A to E, 36 x 6 mm on frame
Finishing	Sanding, Sealer and Glazed
Adhesive	PVA adhesive
Frame	Mineral core frame & Metal Frame
Hinges	Height of 101.6 mm to 114.3 mm and Thickness of 2.67 mm to 5.72 depending on door width and height
Closers	Listed and Labelled, Surface mounted and concealed
Latch/Locks	Listed and Labelled. Minimum Latch throw of 12.7 mm for single and 16 mm for double
Mortise	Mortise latch set of 27mm x 114mm x 165 mm
Fire Exit Hardware	Listed and Labelled Fire exit device
Bolts	Listed and Labelled
Lite Kits	Positive Pressure as per UBC standard 7-2-1997, UL 10C
Positive Pressure	Category A, B- Mineral Core, C-standard frame edge sealing, G-edge seal system, H-smoke & draft control gasketing
Testing Standards	UBC-7-2-97/UL 10 C Positive Pressure
Stiles	High Density Mineral Core 40mm x 30 mm of 1263-1378 kg/m ³ density
Rails	High Density Mineral Core 40mm x 30 mm of 1263-1378 kg/m ³ density
Thickness	43 mm
Veneer	As per requirement
Glazing	Maximum Area of 2397 sq.in

VULCAN INDUSTRIES LLC

P.O.BOX: 15007, AJMAN, U.A.E.

TEL: +9716-7436665, FAX: +9716-7437033, MOB: +97150-6287115

Email: info@vulcanuae.com, Web: www.vulcanuae.com



DOOR TYPES/CORE/GLAZING/INTUMESCENT STRIPS/ARCHITRAVE OPTIONS

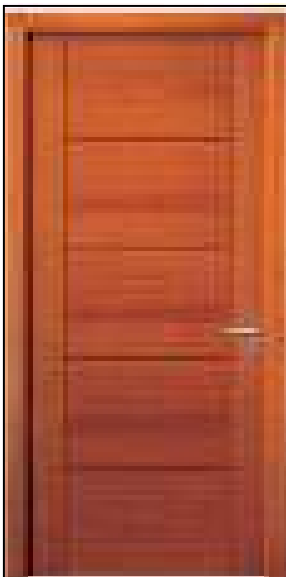

VULCAN INDUSTRIES LLC

P.O.BOX: 15007, AJMAN, U.A.E.

TEL: +9716-7436665, FAX: +9716-7437033, MOB: +97150-6287115

Email: info@vulcanuae.com, Web: www.vulcanuae.com



ACOUSTIC DOORS

Vulcan Timber Acoustic Doors are extremely high performance sound reducing door sets. These high quality door sets are available in a wide range of finishes and are fire rated. Vulcan Wooden acoustic doors can be used in areas which require high sound reduction performance such as radio/TV studios, music rooms, interview rooms, cinemas, schools and confidential offices etc.

Applications:

VULCAN single and double acoustic internal timber doorsets are available in a wide range of wood and laminate finishes and are fire rated. They are used wherever high sound reduction performance is required between noise sensitive areas such as:

- radio/TV studios
- music studios
- music practice rooms
- theatres and cinemas
- interview rooms
- Boardrooms
- private offices
- conference rooms
- consulting rooms
- hotel suites/rooms

Note: The term 'doorset in this leaflet refers to complete assemblies (including frame, seals, threshold, doorleaf and hinges). This is because to achieve the optimum fire and acoustic performance, the total Defender doorset must be fitted complete.

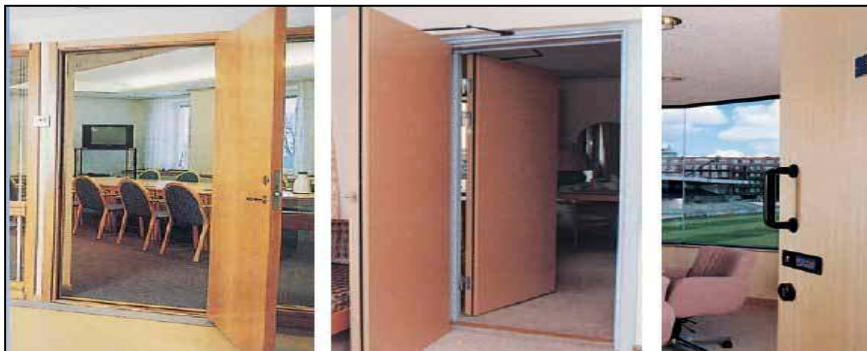

VULCAN INDUSTRIES LLC

P.O.BOX: 15007, AJMAN, U.A.E.

TEL: +9716-7436665, FAX: +9716-7437033, MOB: +97150-6287115

Email: info@vulcanuae.com, Web: www.vulcanuae.com



NOMINAL WEIGHT

Single leaf 42 decibel doorset 85Kg.
Single leaf 35 decibel doorset 74Kg.
Double leaf 41 decibel doorset 144Kg.
Double leaf 35 decibel doorset 123Kg.

IRONMONGERY

Door sets are supplied with hinges and seals pre-fitted. Handles, lock cases etc. are usually supplied and fitted by others to suit the rest of the building.

FINISHES

Veneers: Standard veneers.

VULCAN acoustic door sets are high performance constructions and are available in two standard acoustic ratings:

- High performance version is called Defender-44 and has sound reduction of $R_w = 44$ decibels. (Double leaf doorset is 41 decibel rating).
- Medium performance version is called Defender-35 and has sound reduction of $R_w = 35$ decibels.
- Other acoustic performance ratings such as 38 decibels are available on request.

Standard sizes

Single leaf doorsets

External overall doorframe size: 2110mm high x 1012 mm wide.
Door leaf size: 2040mm high x 926mm wide.

Double leaf doorsets

External overall doorframe size: 2110mm high x 1790 mm wide.
Door leaf size: 2040mm high x 850mm/850mm wide.

ACOUSTIC SEALS

Perimeter seals are integrally fitted in the frames and an automatic lift threshold seal at the base of the door leaf. Other seals may be available on request.

NB: All the pictures and logos shown for illustration purpose only and should be rechecked with Vulcan before any final conclusion

VULCAN INDUSTRIES LLC

P.O.BOX: 15007, AJMAN, U.A.E.

TEL: +9716-7436665, FAX: +9716-7437033, MOB: +97150-6287115

Email: info@vulcanuae.com, Web: www.vulcanuae.com